

Cable Tray Support System



المير للصناعات ALMEER INDUSTRIES

www.almeer.com.kw



شركة المير للخدمات الفنية ذ.م.م.

Subsidiary of ALMEER TECHNICAL SERVICES CO. W.L.L.





INTRODUCTION

Almeer Industries established in the year 1997, has been in the business offering a wide range of services in manufacture of Panels for various applications, Street Lighting Poles, Junction Boxes, Cable Trays & Accessories, Unistrut Channels, Wire mesh, Expanded metal, Profiled Sheets etc., for Oil & Gas, Petrochemical, Power and other major industries in Kuwait. It is an ISO 9001: 2008, ISO 14001: 2004 & ISO 18001: 2007 Certified Company with standardization worked into all facets of its work.

Almeer manufacturing facility is located in Amghara Industrial Area with modern machineries and equipments. The workshop is located on 10,000 Sq.mtrs of area which consists of Overhead Office, Stores and well laid down area for fabrication, machine shop, CNC Operation, Lighting Pole Machinery, Industrial blasting, Power coating plant, Hot-dip galvanization plant and computerized, manual & chemically etched engraving facilities. The workshop is equipped with overhead crane for material handling and other maintenance services.

We stride to provide reliable, highest quality and economic solutions to our customers. As we continue to build and strengthen our partnership, we are committed to achieve 100% customer satisfaction and earn your trust and loyalty.

CHANNEL SUPPORT SYSTEM

SUPPORT CHANNEL-SINGLE

Standard Materials : Rolled Steel ASTM A36
Standard Finishes : Hot Dip Galvanized

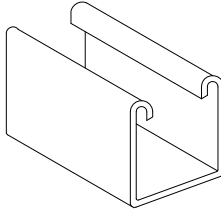

PLAIN TYPE

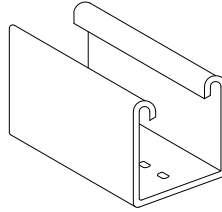

SLOTTED TYPE

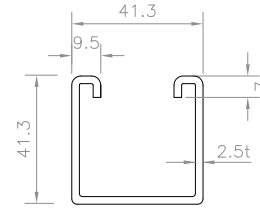

41.3x41.3 MM

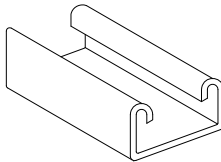

PLAIN TYPE

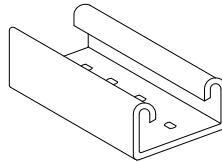

SLOTTED TYPE

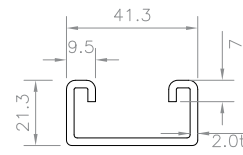

41.3x21.3 MM

SUPPORT CHANNEL-DOUBLE

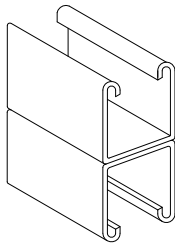

DOUBLE TYPE

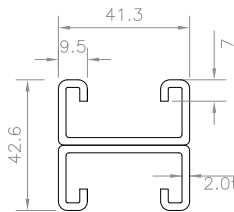

41.3x42.6 MM

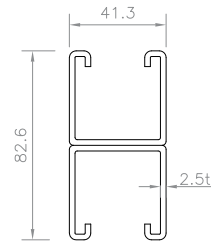

41.3x82.6 MM

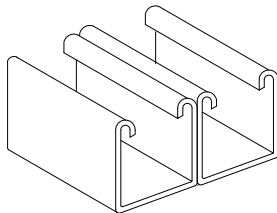

COMBINATION TYPE

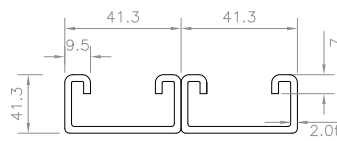

82.6x21.3 MM

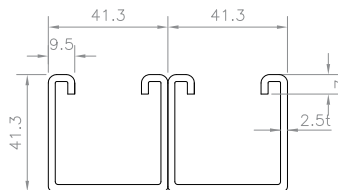

82.6x41.3 MM

CHANNEL SIZE 41.3x41.3		UNIT : mm
CATALOG NO.		Length(mm)
Single Type	Double Type	
SCS 4110	SCD 4110	1000
SCS 4120	SCD 4120	2000
SCS 4130	SCD 4130	3000
Combination Type	C-SCD 3000	3000
THICKNESS 2.0 , 2.3 , 2.5 , 2.6 MM		

CHANNEL SIZE 41.3x21.3		UNIT : mm
CATALOG NO.		Length(mm)
Single Type	Double Type	
SCS 2110	SCD 2110	1000
SCS 2120	SCD 2120	2000
SCS 2130	SCD 2130	3000
Combination Type	C2-SCD 3000	3000
THICKNESS 2.0 MM		

All Dimensions are in MM

All Dimensions are in MM

CHANNEL SUPPORT SYSTEM

POST BASE FOR SINGLE CHANNEL (PBS)

Standard Materials : Rolled Steel ASTM A36
Standard Finishes : Hot Dip Galvanized

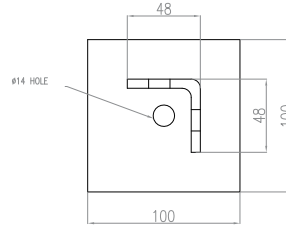
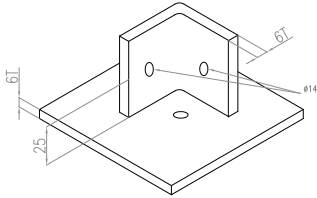

POST BASE FOR SINGLE CHANNEL (PBSH)

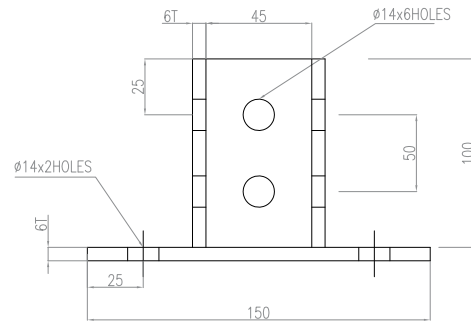
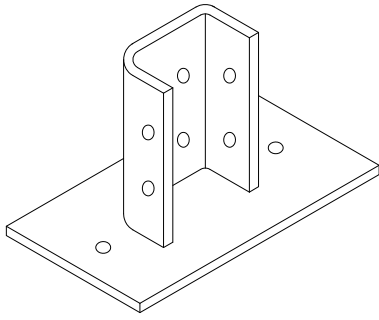

POST BASE FOR DOUBLE CHANNEL (PBD)

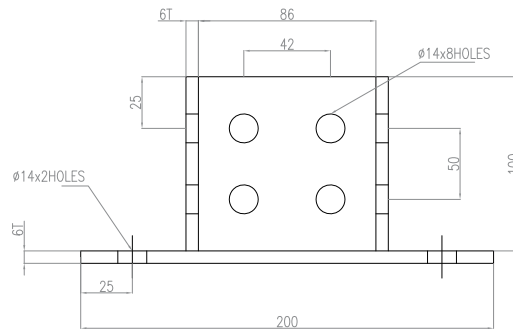
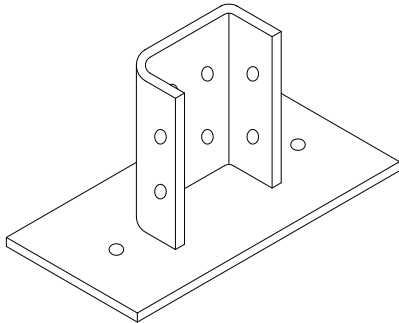

POST BASE FOR DOUBLE CHANNEL (PBDH)

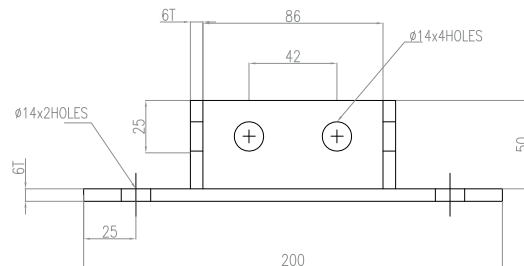
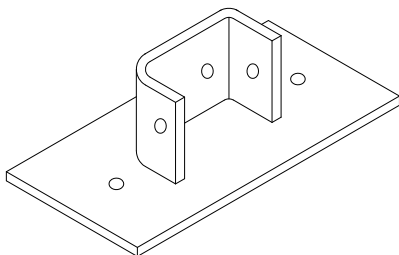

All Dimensions are in MM

CHANNEL SUPPORT SYSTEM

SUPPORT BRACKETS

Standard Materials : Rolled Steel ASTM A36

Standard Finishes : Hot Dip Galvanized

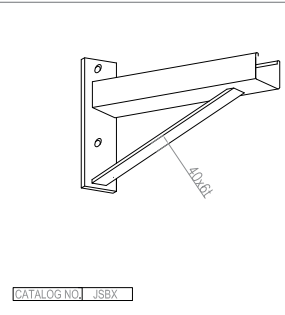
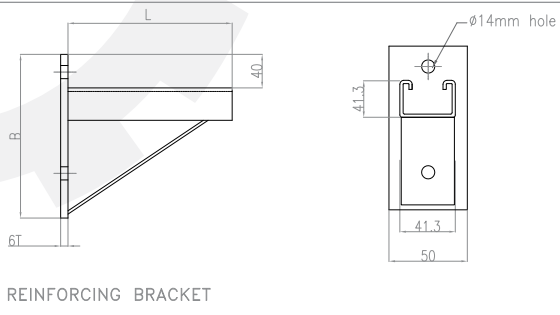
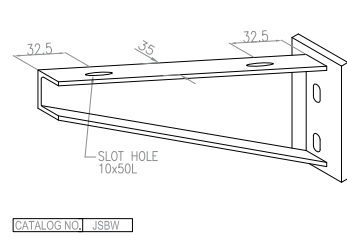
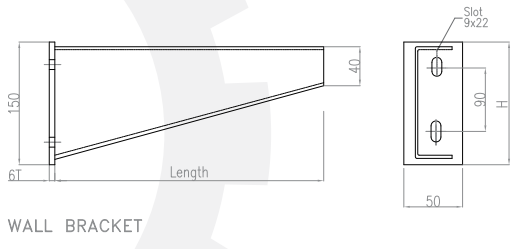
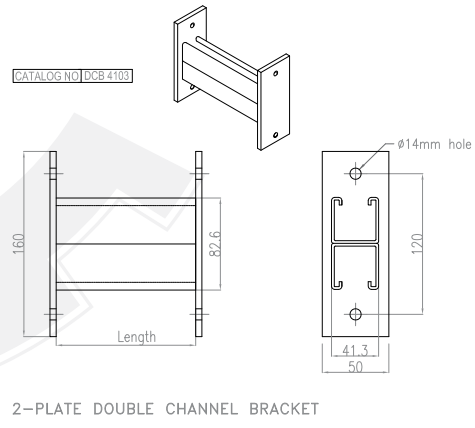
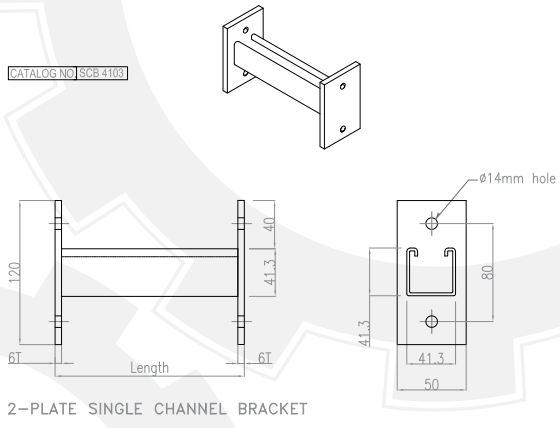
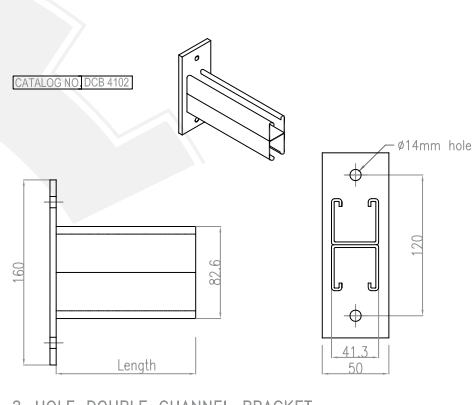
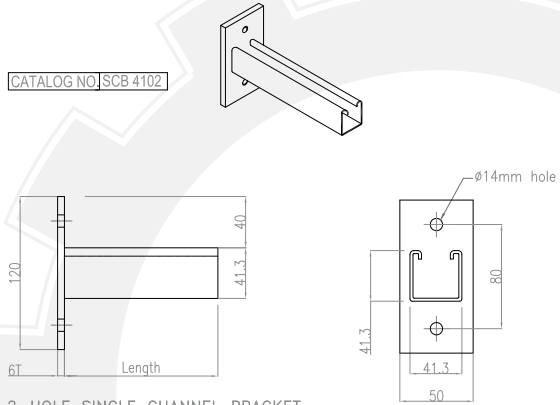

CHANNEL SUPPORT SYSTEM

Standard Materials : Rolled Steel ASTM A36

Standard Finishes : Hot Dip Galvanized

1-HOLE JOINT PLATE

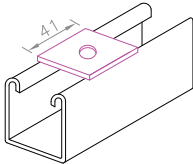

Thickness - 6mm
CATALOG NO. SSA-1001

2-HOLE JOINT PLATE

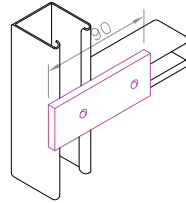

Thickness - 6mm
CATALOG NO. SSA-1002

2-HOLE JOINT PLATE

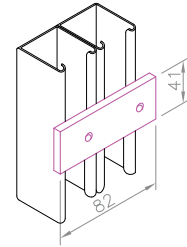

Thickness - 6mm
CATALOG NO. SSA-1003

3-HOLE JOINT PLATE

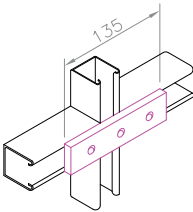

Thickness - 6mm
CATALOG NO. SSA-1004

4-HOLE JOINT PLATE

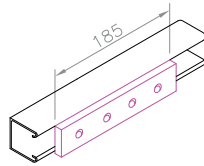

Thickness - 6mm
CATALOG NO. SSA-1005

3-HOLE ANGLE PLATE

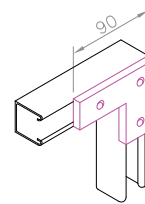

Thickness - 6mm
CATALOG NO. SSA-1006

4-HOLE TEE PLATE

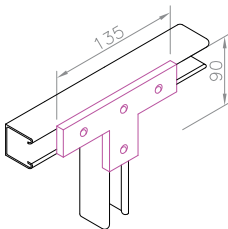

Thickness - 6mm
CATALOG NO. SSA-1007

5-HOLE CROSS PLATE

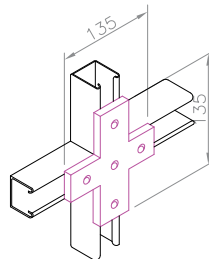

Thickness - 6mm
CATALOG NO. SSA-1008

4-HOLE CORNER PLATE

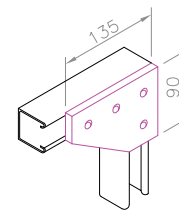

Thickness - 6mm
CATALOG NO. SSA-1009

2-HOLE ANGLE FITTING

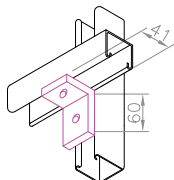

Thickness - 6mm
CATALOG NO. SSA-1010

2-HOLE ANGLE FITTING

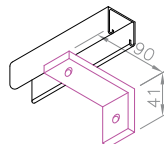

Thickness - 6mm
CATALOG NO. SSA-1011

2-HOLE ANGLE PLATE

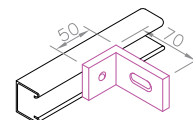

Thickness - 6mm
CATALOG NO. SSA-1012

All Dimensions are in MM

CHANNEL SUPPORT SYSTEM

Standard Materials : Rolled Steel ASTM A36
Standard Finishes : Hot Dip Galvanized

3-HOLE ANGLE FITTING

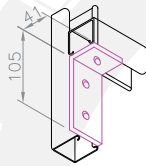

Thickness - 6mm
CATALOG NO. SSA-1013

3-HOLE ANGLE FITTING

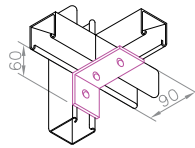

Thickness - 6mm
CATALOG NO. SSA-1014

4-HOLE ANGLE FITTING

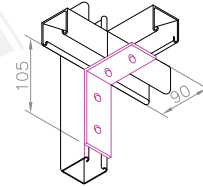

Thickness - 6mm
CATALOG NO. SSA-1015

2-HOLE ANGLE FITTING

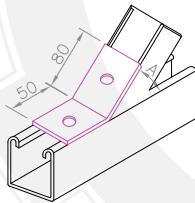

CATALOG NO.	A
SSA-1016	30°
SSA-1017	45°
SSA-1018	60°

4-HOLE ANGLE FITTING

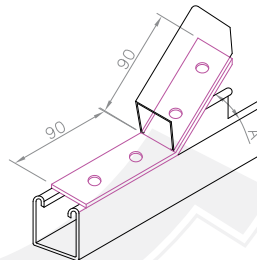

CATALOG NO.	A
SSA-1019	30°
SSA-1020	45°
SSA-1021	60°

2-HOLE ANGLE FITTING

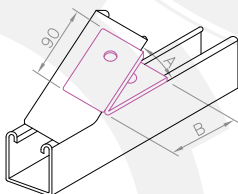

CATALOG NO.	A	B
SSA-1022	45°	75
SSA-1023	60°	70

4-HOLE ANGLE FITTING

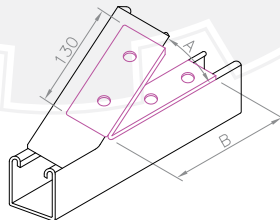

CATALOG NO.	A	B
SSA-1024	45°	125
SSA-1025	60°	120

5-HOLE SINGLE WING FITTING

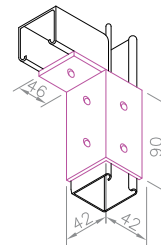

Thickness - 6mm
CATALOG NO. SSA-1026

2-HOLE SINGLE WING FITTING

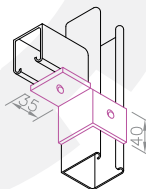

Thickness - 6mm
CATALOG NO. SSA-1027

2-HOLE SINGLE WING FITTING

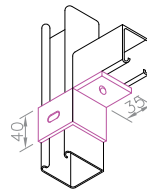

Thickness - 6mm
CATALOG NO. SSA-1028

4-HOLE SINGLE WING FITTING

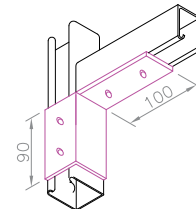

Thickness - 6mm
CATALOG NO. SSA-1029

CHANNEL SUPPORT SYSTEM

Standard Materials : Rolled Steel ASTM A36

Standard Finishes : Hot Dip Galvanized

4-HOLE SINGLE WING FITTING

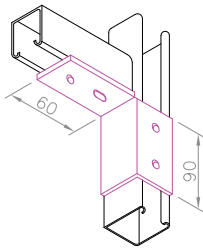

Thickness - 6mm
CATALOG NO. SSA-1030

5-HOLE SINGLE WING FITTING

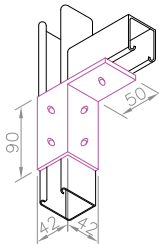

Thickness - 6mm
CATALOG NO. SSA-1031

3-HOLE DOUBLE WING FITTING

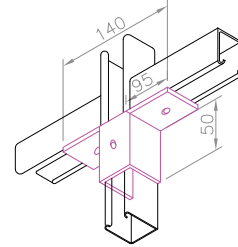

Thickness - 6mm
CATALOG NO. SSA-1032

3-HOLE DOUBLE WING FITTING

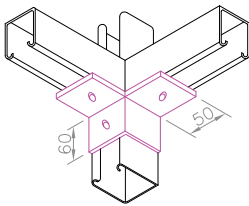

Thickness - 6mm
CATALOG NO. SSA-1033

4-HOLE DOUBLE WING FITTING

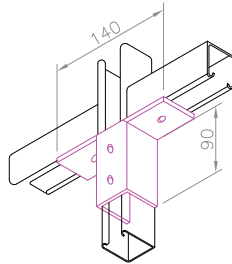

Thickness - 6mm
CATALOG NO. SSA-1034

6-HOLE DOUBLE WING FITTING

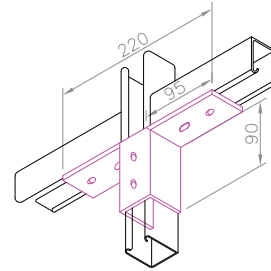

Thickness - 6mm
CATALOG NO. SSA-1035

"U" SUPPORT (DOUBLE)

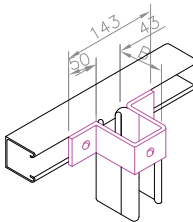

B=81,41&61mm
Thickness - 6mm
CATALOG NO. SSA-1036

"U" SUPPORT (SINGLE)

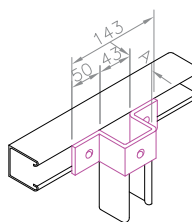

A=40 & 20mm
Thickness - 6mm
CATALOG NO. SSA-1037

2-HOLE Z - SUPPORT

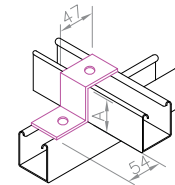

A=41 & 21mm
Thickness - 6mm
CATALOG NO. SSA-1038

4-HOLE SHELF BRACKET

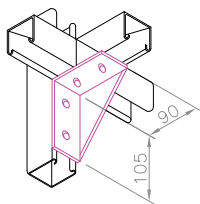

Thickness - 6mm
CATALOG NO. SSA-1039

4-HOLE SHELF BRACKET

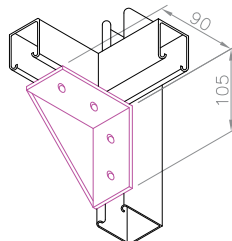

Thickness - 6mm
CATALOG NO. SSA-1040

3-HOLE Z - SUPPORT

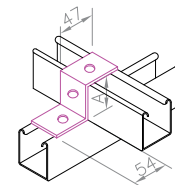

Thickness - 6mm
CATALOG NO. SSA-1041

All Dimensions are in MM

CHANNEL SUPPORT SYSTEM

Standard Materials : Rolled Steel ASTM A36
Standard Finishes : Hot Dip Galvanized

BRACE BRACKET

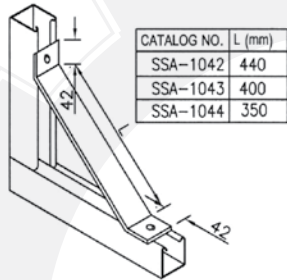

12-HOLE DOUBLE WING FITTING

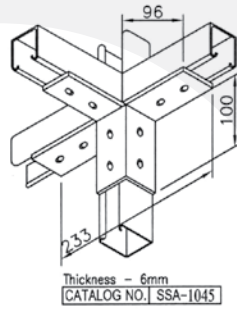

6-HOLE DOUBLE WING FITTING

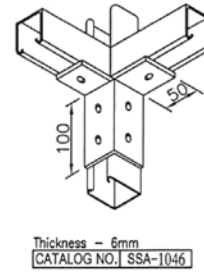

4-HOLE ANGLE FITTING

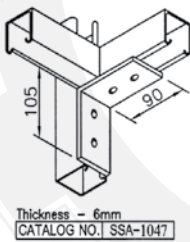

4-HOLE ANGLE FITTING

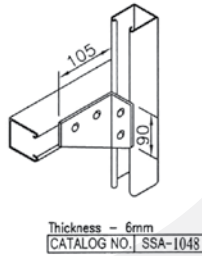

2-HOLE JOINT U-PLATE

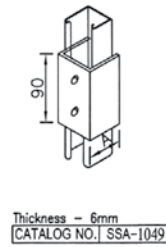

4-HOLE ANGLE FITTING

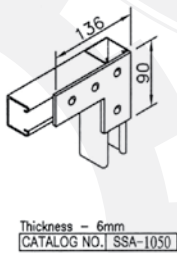

3-HOLE TEE PLATE

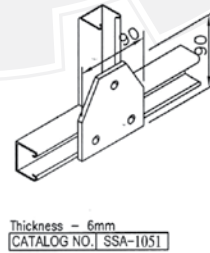

4-HOLE TEE PLATE

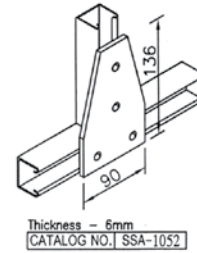

5-HOLE TEE PLATE

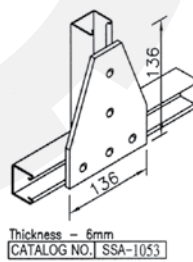

6-HOLE CROSS PLATE

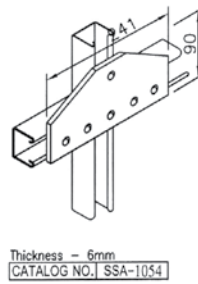

7-HOLE CROSS PLATE

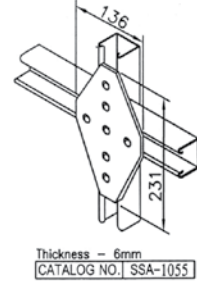

CHANNEL SUPPORT SYSTEM

BEAM CLAMP

Standard Materials : Rolled Steel ASTM A36

Standard Finishes : Hot Dip Galvanized

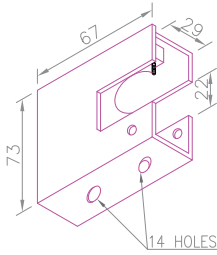

Thickness - 3.2mm
CATALOG NO. SSA-1056

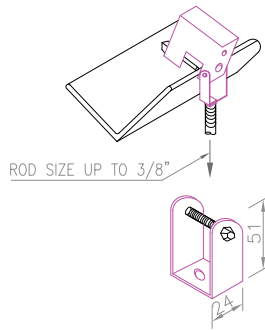

Thickness - 4mm
CATALOG NO. SSA-1057

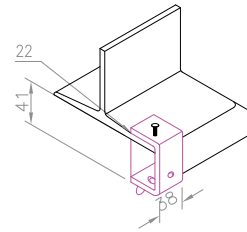

Thickness - 8mm
CATALOG NO. SSA-1058

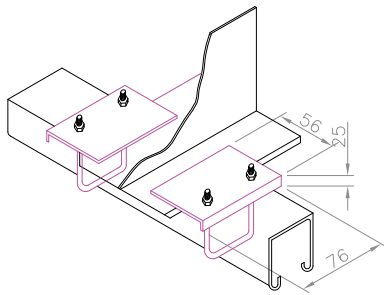

Thickness - 6mm
CATALOG NO. SSA-1059

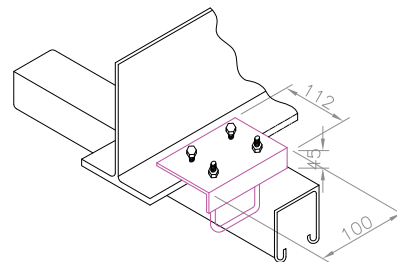

Thickness - 8mm
CATALOG NO. SSA-1060

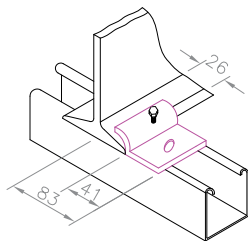

Thickness - 8mm
CATALOG NO. SSA-1061

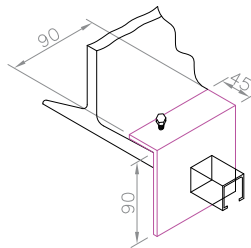

Thickness - 6mm
CATALOG NO. SSA-1062

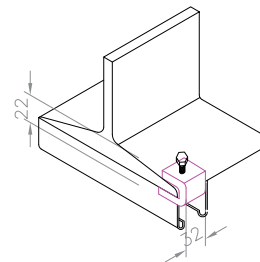

Thickness - 6mm
CATALOG NO. SSA-1063

CHANNEL SPRING NUT

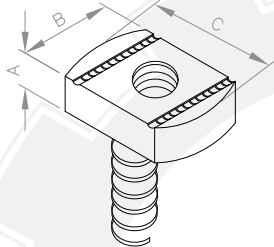

MATERIAL : 1) STEEL (ELECTRO GALVANIZED)
2) STEEL (HOT DIP GALVANIZED)
3) STAINLESS STEEL

CATALOG NO.	THREAD (METRIC)	THREAD (INCH)	A	B	C
CSN-6	M6 x 1.0P	1/4 ~20 UNC	6	20	35
CSN-8	M8 x 1.25P	5/16 ~18 UNC	6	20	35
CSN-10	M10 x 1.5P	3/8~16 UNC	9	20	35
CSN-12	M12 x 1.75P	1/2 ~13 UNC	12	20	35
CSN-16	M16 x 2.0P	5/8 ~11 UNC	12	25	35

CHANNEL NUT

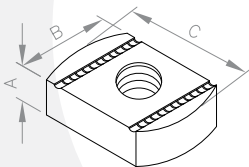

CATALOG NO.	THREAD (METRIC)	THREAD (INCH)	A	B	C
CN-6	M6 x 1.0P	1/4 ~20 UNC	6	20	35
CN-10	M10 x 1.5P	3/8 ~16 UNC	9	20	35
CN-12	M12 x 1.75P	1/2~13 UNC	9	20	35

THREAD ROD

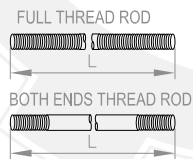

CATALOG NO.	THREAD (METRIC)	THREAD (INCH)
TR-6	M6 x 1.0P	1/4 ~20 UNC
TR-8	M8 x 1.25P	5/16 ~18 UNC
TR-10	M10 x 1.5P	3/8~16 UNC
TR-12	M12 x 1.75P	1/2 ~13 UNC
TR-16	M16 x 2.0P	5/8 ~11 UNC

THREAD ROD COUPLING

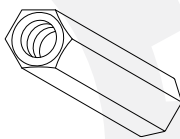

CATALOG NO.	THREAD (METRIC)	THREAD (INCH)
RC-6	M6 x 1.0P	1/4 ~20 UNC
RC-8	M8 x 1.25P	5/16 ~18 UNC
RC-10	M10 x 1.5P	3/8~16 UNC
RC-12	M12 x 1.75P	1/2 ~13 UNC
RC-16	M16 x 2.0P	5/8 ~11 UNC

HEX HEAD BOLT

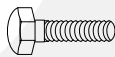

PAN HEAD MACHINE SCREWS

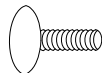

GROOVED HEX-HEAD BOLT

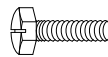

TAPERED HEX-HEAD BOLT

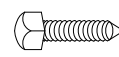

SHANK BOLT



SQUARE NUTS



HEXAGONAL NUTS



FLAT WASHERS



SPRING WASHERS



All Dimensions are in MM



المير للصناعات ALMEER INDUSTRIES

HEAD OFFICE: P.O. Box 9240 Ahmadi, 61003 Kuwait

Tel. : +965 2398 6594 (10 Lines)

Hotline: 18 40 800

Fax : +965 2398 0682 / 6574

E-mail : atsco@almeer.com.kw



www.almeer.com.kw

FACTORY: AMGHARA INDUSTRIAL AREA

Tel. : +965 2457 1395 / 4391

Fax : +965 2457 1396

E-mail : factory@almeer.com.kw